

Brushless® Screwdriver

Screw Counter / Pulse Counter

BLG-ZERO1 Series

BLG-ZERO1 (DC Type)



Anyone can be a skilled craftsman in Just 30 Seconds.

- Direct teaching makes it easy to configure settings.
- The pulse of the motor is counted, enabling real time detection of screw fastening errors with a high degree of accuracy.
- Errors such as mixing of wrong types of screws, unseated screws, cam out, stripped screw holes, or parts caught in screws can be detected.
- It displays the remaining number of screws to fasten every time a screw is fastened.

Lever Start Type

Lever Start Type

Unit : mm

BLG-4000ZERO1



Two-way Start System

Two-way Start System

Unit : mm

BLG-5000ZERO1



Hi-speed rotation

BLG-5000ZERO1-15



Hi-speed rotation

BLG-5000ZERO1-18



Hi-torque

BLG-5000ZERO1-HT



Note: CCC certified models have different specification and order codes from the standard models. Please contact HIOS distributors before ordering.

BLG-ZERO1 Series Specifications

Specifications

Model name		BLG-4000ZERO1	BLG-5000ZERO1	BLG-5000ZERO1-15	BLG-5000ZERO1-18	BLG-5000ZERO1-HT	
Output torque range	N·m	0.1-0.55	0.2-1.2	0.3-1.0	0.5-1.5	0.5-2.0	
	lbf·in	0.9-4.8	1.7-10	2.6-10	4.3-13	4.3-17	
	(Kgf·cm)	(1-5.5)	(2-12)	(3-10)	(5-15)	(5-20)	
Torque switching		Stepless Adjustment	Stepless Adjustment	Stepless adjustment	Stepless Adjustment	Stepless Adjustment	
Unloaded Rotation	HI	1.000	1.000	1.500	1.800	730	
	LOW	690	690	1.000	1.200	-	
Screw Size (mm)	Machine Screw	1.4-2.6	2.0-3.0	2.3-3.0	2.3-3.0	2.0-4.0	
	Tapping Screw	1.4-2.3	2.0-3.0	2.0-2.6	2.0-2.6	2.0-3.0	
Bit Drive	HIOS Shank	H4	H4	H4	H5 and 5HEX	H5 and 5HEX	
	HEX Shank	1/4HEX	H5 and 5HEX or 1/4HEX	H5 and 5HEX or 1/4HEX	1/4HEX	1/4HEX	
Power Supply	T-45BL	○	○	○★	-	○★	
	T-70BL	○	○	○★	○★	○★	
Accessories	Bit (one each)	H4	+ #0 (Ø2.5×40mm) + #1 (Ø4.0×40mm)	+ #1 (Ø4.0×40mm) + #2 (Ø4.0×40mm)	+ #1 (Ø4.0×40mm) + #2 (Ø4.0×40mm)	-	
		H5	-	+ #1 (Ø5.0×60mm) + #2 (Ø5.0×60mm)	+ #1 (Ø5.0×60mm) + #2 (Ø5.0×60mm)	+ #1 (Ø5.0×60mm) + #2 (Ø5.0×60mm)	
		1/4HEX	+ #1 (Ø5.0×50mm) + #2 (Ø5.0×50mm) - (Ø5.0×50mm)	+ #1 (Ø5.0×50mm) + #2 (Ø5.0×50mm) - (Ø5.0×50mm)	+ #1 (Ø5.0×50mm) + #2 (Ø5.0×50mm) - (Ø5.0×50mm)	+ #1 (Ø5.0×50mm) + #2 (Ø5.0×50mm) - (Ø5.0×50mm)	+ #1 (Ø5.0×50mm) + #2 (Ø5.0×50mm) - (Ø5.0×50mm)
	Spring	White					
	Cord length (m)	2m(6P)					
L-shaped HEX wrench		Width across flats: 5mm, 1 pc		Width across flats: 5mm, 1 pc		Width across flats: 5mm, 1 pc	

Use only 2(HI) power outlet with the ★models. These models may not perform properly on 1(LOW) power outlet.

The 3-step procedure of "1-6-1" makes it easy to configure settings so that the driver itself securely guards against improper screw fastening.

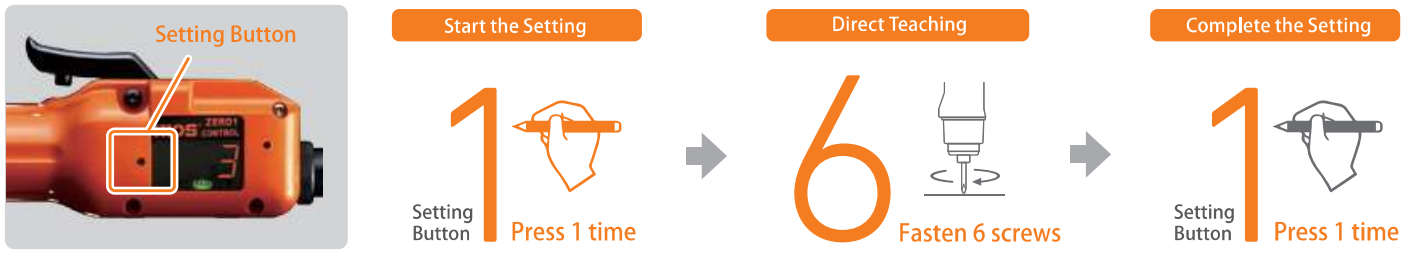

Detectable errors

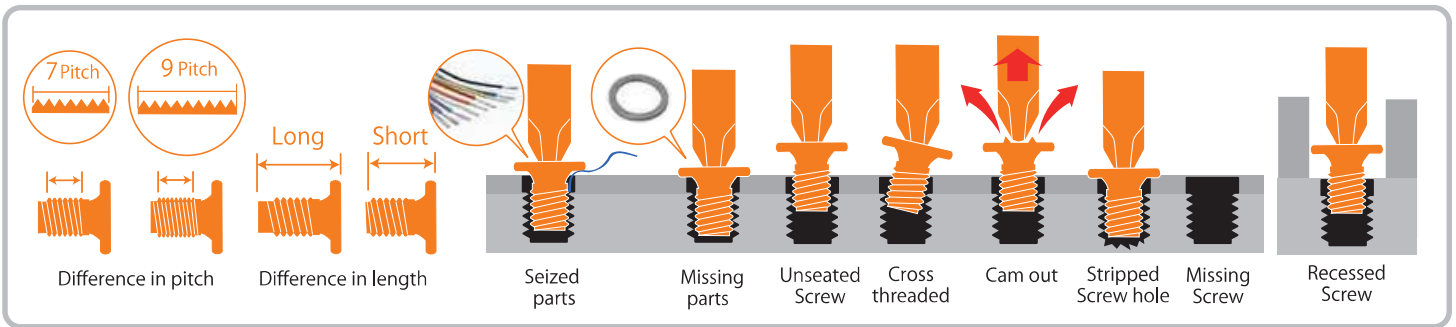

Accessories

BLG-BZERO1 Accessories

Accessories

Accessories

Suction(Vacuum) Attachment for BLG Series

By negative pressure, the effort needed to pick up screws is reduced. This attachment can even pick up non-ferrous screws such as stainless steel screws by vacuuming, and improve operation efficiency. It also removes powder dust generated in screw fastening.

Order guide

(A),(B) and (C) below needed to be purchased separately .

* The size of (A) and (B) depends on the screw size. For more information, please refer to P. 63-64.

Model	(A) Mouthpiece model	(B) Bit length	(C) Suction Attachment model
BLG-4000ZERO1	F3-Standard 18mm	H4 60mm	BLGQ4-SET
BLG-5000ZERO1		H4 40mm	BLQ5-SET/BLQ5-SET-ESD*
BLG-5000ZERO1-15		H4 60mm	BLQ5N-SET/BLQ5N-SET-ESD*

Note: The Suction Attachment cannot be used with 1/4HEX.

* ESD is anti-electrostatic

Please contact HIOS distributors for the attachment for the BLG-5000ZERO1-18

Vertical Screwdriver Operating Stand

VMS-40/VMS-50

The stand keeps the screwdriver in a vertical position, allowing accurate screw fastening.



Compatible screwdrivers:

BLG-4000ZERO1
BLG-5000ZERO1 Series

▶ See P.46 for details.

Output torque guide (HI input)

BLG-4000ZERO1

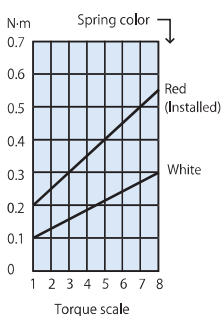

BLG-5000ZERO1

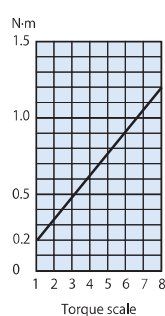

BLG-5000ZERO1-15

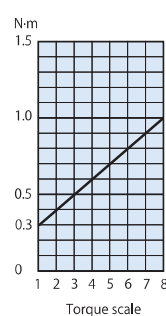

BLG-5000ZERO1-18

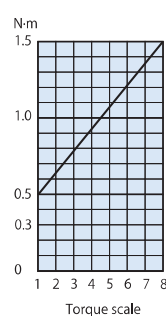

BLG-5000ZERO1-HT

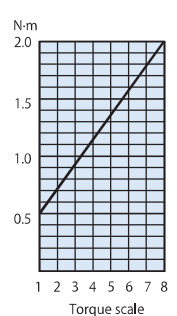

*There are two types of spring for torque adjustment: for HI (originally fixed to the unit) and for Low (accessory). Use one of them depending on your operating conditions.