



## DENTAL LABORATORY DUST AND FUME EXTRACTION SOLUTIONS

# DentalPRO 250

### SINGLE USER DUST EXTRACTION SYSTEM

FOR **HAND FINISHING** DENTAL APPLICATIONS.

BOFA's DentalPRO 250 under bench dust extraction system effectively removes smaller particulates generated during the hand finishing of dental implants.

The DentalPRO 250 is ideally suited to manual bench top applications, where technicians need to be able to work without restriction, but in the knowledge that dust particles are being effectively removed to maintain a safe working environment.

The pump used in the DentalPRO 250 dust extraction system is brushless and designed for continuous running to in excess of 30,000 hours before requiring servicing. The bag filter has a large 6.4 litre capacity and the HEPA filter is very high efficiency.

This single user system combines maximum operator protection in a small footprint, easy to operate unit with low running costs.

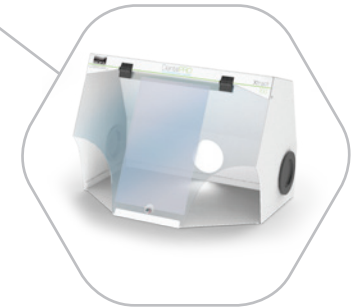

#### STANDARD FEATURES:

- High efficiency filters (99.997% @ 0.3 microns)
- Large capacity filter bag
- Simple operation
- Low running costs
- Small footprint
- Quiet operation

#### OPTIONAL FEATURES:

- Foot switch
- 90° spigot lid



## TECHNICAL DATA

	EU	US
Dimensions (HxWxD)	522 x 285 x 290mm	20.6 x 11.2 x 11.4"
Cabinet construction	Powder coated mild steel	
Max airflow / pressure	180m <sup>3</sup> /hr / 30mbar	105cfm / 30mbar
Electrical data	230v 1ph 50/60Hz Full load current: 0.9 amps / 0.135w Fuse rating 2 amps	115v 1ph 50/60Hz Full load current: 1.2 amps / 0.135w Fuse rating 2 amps
Noise level	< 58dBA (at typical operating speed)	
Weight	8kgs	18lbs
Approvals	CE	

## PRE FILTER BAG SPECIFICATIONS

Filter holding capacity	6.4 ltrs
Filter media	Polyester
Filter media construction	Bag filter
Filter efficiency	H10 (95% @ 0.3 microns)

## HEPA FILTER SPECIFICATIONS

HEPA filter media	Glass fibre
HEPA media construction	Maxi pleat construction with webbing spacers
Filter efficiency	99.997% @ 0.3 microns

## AIRFLOW THROUGH FILTERS

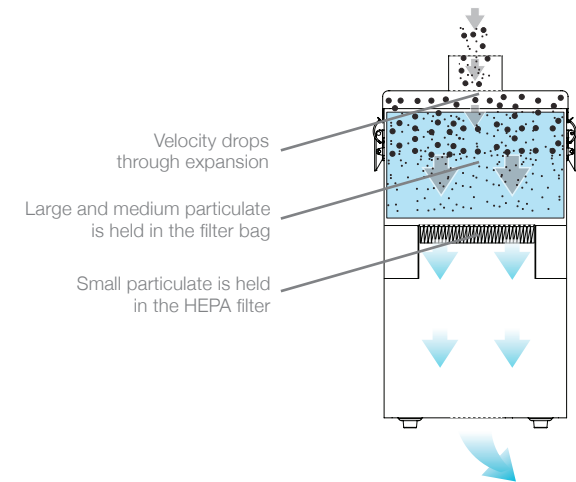
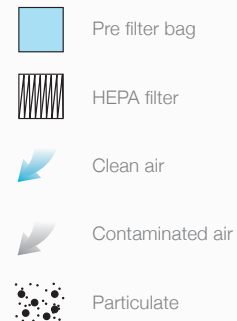

## TECHNICAL SPECIFICATION

- Hose inlet - 75mm
- Unit lid
- Latch
- Feet
- Power inlet
- Exhaust outlet
- Filter change indicator
- ON / OFF switch
- Optional foot switch socket
- Optional lid with 90° spigot inlet

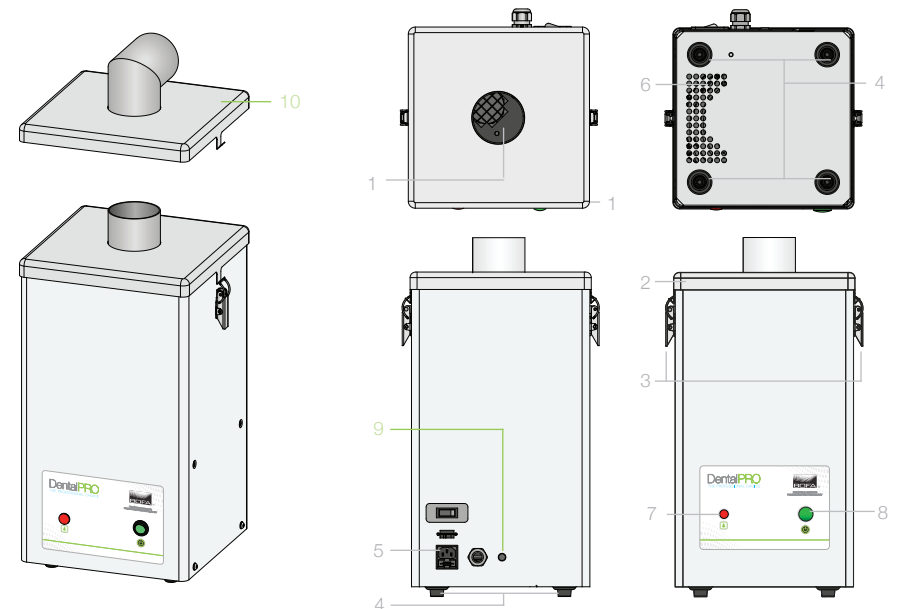

# 1 UNIT

## A. UNIT

Model	Voltage	Part Number
DentalPRO 250 Powder coated unit Single port 75mm lid	230V	DL0142A0000
	115V	DL0141A0000
DentalPRO 250 Powder coated unit Single port 75mm 90° spigot lid	230V	DL0142A8000
	115V	DL0141A8000



## B. UNIT OPTION

Description	Part Number
Foot switch (ON / OFF Operation)	A1070184

# FILTERS

## REPLACEMENT FILTERS

Description	Part Number
Bag filter	A1030378
HEPA filter	A1030379

Other hose kits and filters are available. All of the above units are fitted with our standard filter combinations. For specific applications please call us for details. Replacement filters should always be ordered using the part number on the filters inside your extractor to ensure the correct filter is ordered. Datasheet correct at time of print.

# 2 HOSE KITS

## A. BENCH TOP HOSE KIT

NEEDED IF ORDERING FROM MENU **3A**

Description	Part Number
Hose kit with floptop table mount to connect to DentalPRO desk accessory	A1020309



## B. CABINET HOSE KIT

NEEDED IF ORDERING FROM MENU **3B**

Description	Part Number
Hose kit to connect to DentalPRO Xtract cabinet	A1020068



# 3 ACCESSORIES

## A. ARM ACCESSORIES

Number Reference	Description	Part Number
1	DentalPRO LED Light Arm - 50mm Stay Put Arm	A1020314
2	DentalPRO Down Draught Tray - 50mm Flexi Hose	A1020316
3	DentalPRO Plenum Funnel Arm - 50mm Stay Put Arm	A1020315



## B. CABINET ACCESSORIES

Number Reference	Description	Part Number
4	DentalPRO Xtract 100	D0945A0000
5	DentalPRO Xtract 200	D0946A0000
6	DentalPRO Xtract 300	D0947A0000

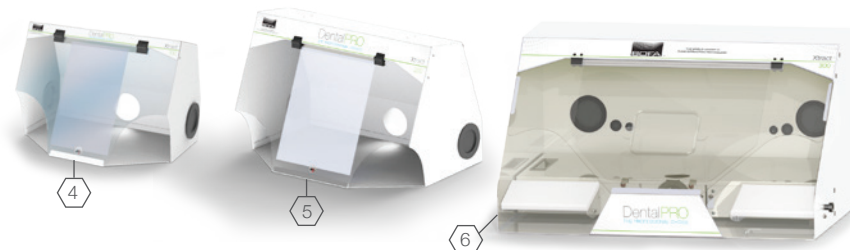

DentalPRO-250:26/9/16V:3.4



**BOFA INTERNATIONAL LTD**

Tel: +44 (0) 1202 699 444 Fax: +44 (0) 1202 699 446 Email: sales@bofa.co.uk Web: www.bofa.co.uk

**BOFA AMERICAS, INC**

Tel: (618) 205 5007 Fax: (866) 707 2632 Email: sales@bofaamericas.com Web: www.bofaamericas.com



British Quality

