



## LASER Fume Extraction Solutions

# AD GoldSEAL RS

Advantage

The **complete solution** for the extraction, filtration and recovery of **precious metals**.

The AD GoldSEAL RS is a dust extraction system designed for the jewellery industry that recovers and collects precious metals.

The metal particles are collected in an easy to remove tray and the HEPA filter can be incinerated to reveal the precious metal collected in the filtration process.

Automatic Flow Control allows the user to preset correct air flow rates, for lower noise levels and allow further protection of the HEPA filter.

### STANDARD FEATURES:

- Reverse Flow filter technology
- Automatic Flow Control
- Auto sensing voltage (90-257v) - For global use
- Filter status warnings
- Removable collection tray
- High pressure turbine
- HEPA filtration
- Lockable unit
- Lockable filter inside unit
- Filter box designed to aid removal of collected gold
- Incinerable filter to recover maximum available gold
- Small footprint
- Tamper proof

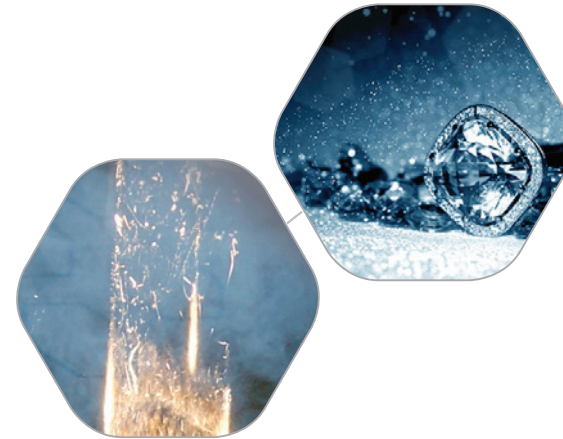

### TECHNOLOGY:

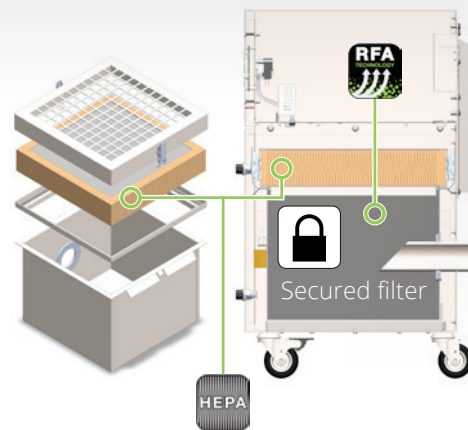

### OPTIONAL FEATURE:

- 24V Remote stop / start interface

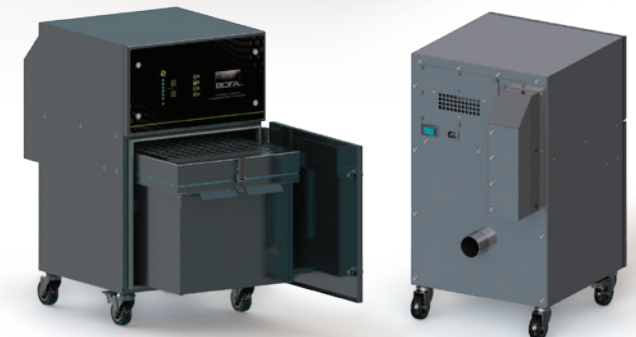

1. UNIT PART NUMBERS			
Model	Feature	Voltage	Part No.
AD GoldSEAL RS Powder Coated		115-230V	L5654A0000
	24V Stop / Start		L5654A0001

2. REPLACEMENT FILTER PART NUMBER	
Description	Part No.
HEPA filter	A1030352

TECHNICAL DATA		
	EU	US
Dimensions (HxWxD)	615 x 377 x 470mm	24.2 x 14.8 x 18.5"
Cabinet construction	Powder coated mild steel	
Airflow / pressure	267m³/hr / 96mbar	157cfm / 96mbar
Electrical data	115-230v 1ph 50/60Hz Full load current: 10 amps / 1100w	
Noise level	< 70dBA (at typical operating speed)	
Weight	25.8kgs	56.9lbs
Approvals	CE	

HEPA FILTER SPECIFICATIONS	
HEPA filter media	Glass fibre
HEPA media construction	Maxi pleat construction with webbing spacers
Filter efficiency	99.997% @ 0.3 microns

Other hose kits and filters are available. All units are fitted with our standard filter combinations. For specific applications please call us for details. Replacement filters should always be ordered using the part number on the filters inside your extractor to ensure the correct filter is ordered. Datasheet correct at time of print.

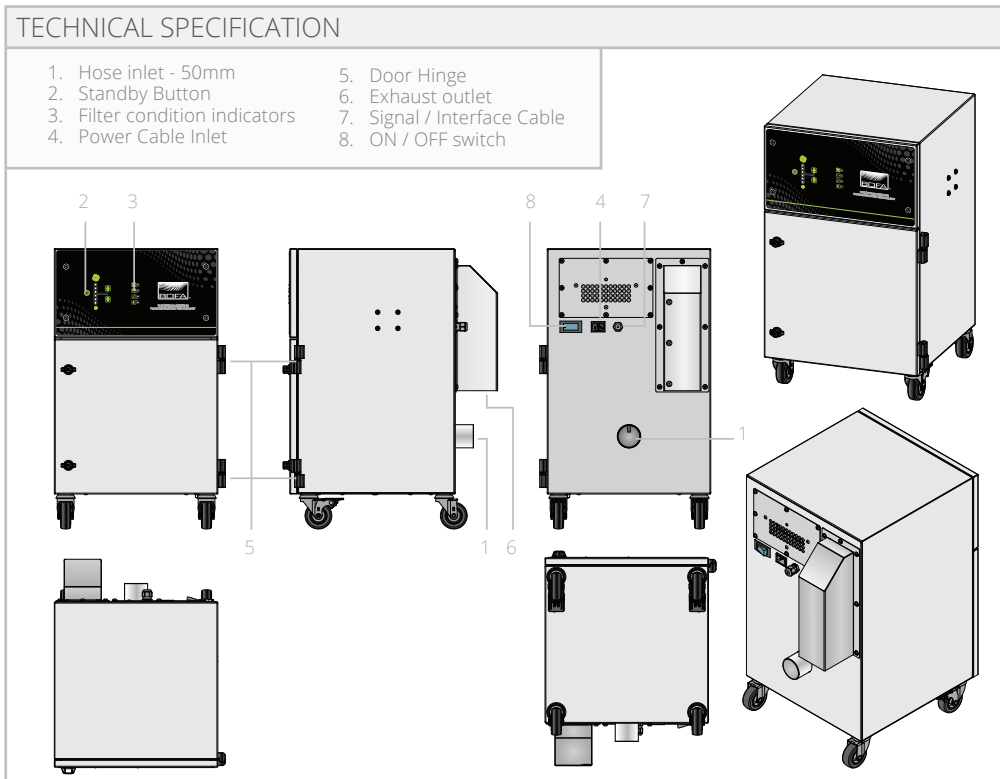
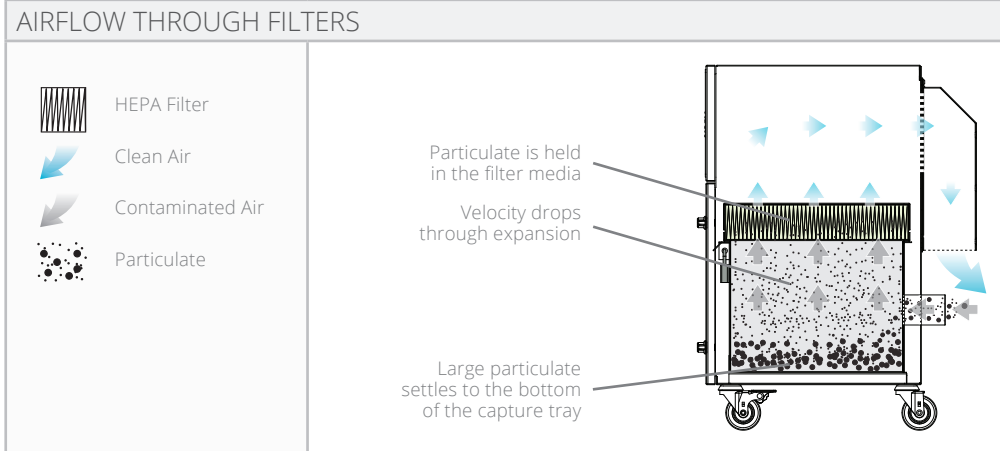

AD-GoldSEAL-RS:15/12/16V:1.2



**BOFA INTERNATIONAL LTD**

Tel: +44 (0) 1202 699 444 Fax: +44 (0) 1202 699 446 Email: sales@bofa.co.uk Web: www.bofa.co.uk

**BOFA AMERICAS, INC**

Tel: (618) 205 5007 Fax: (866) 707 2632 Email: sales@bofaamericas.com Web: www.bofaamericas.com



British Quality

